

FRONT VIEW II SCALE 1:5

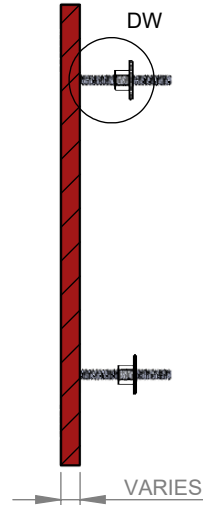

SECTION A-A II SCALE 1:5

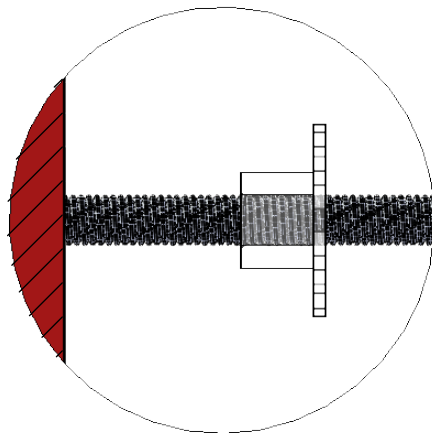

DETAIL DW II SCALE 1:1

RADIUS VARIES BASE ON SIZE  
(0.015-0.135")

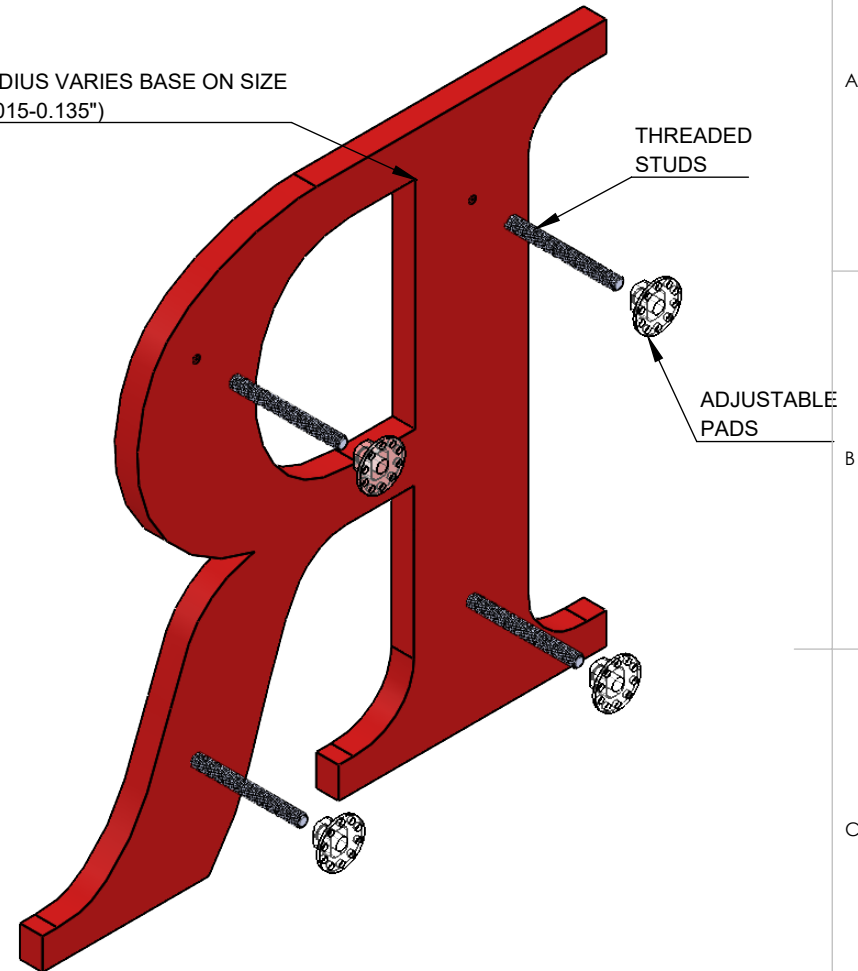

ISOMETRIC BACK VIEW II SCALE 1:3

**NOTES:**

- Minimum 6" high letters
- Combination All mount has stud through pads on both top and bottom mounts.
- Standard Gemini letter styles or per vector art
- Min. 3/8" stroke
- Aluminum 10/24 studs (stainless steel optional)
- Available gauges (1/8", 3/16", 1/4", 3/8", 1/2", 3/4", 1", and 1 1/2" thick)
- Pigmented acrylic or sprayed with acrylic polyurethane paint



TITLE:

**LASER CUT ACRYLIC - COMBINATION ALL MOUNT**

MATERIAL:

**IMPACT MODIFIED  
ACRYLIC**

PRODUCT TYPE:

**PLASTIC LETTERS**

DWG NO. LASR50

REV 02/25/22

SCALE: AS INDICATED

SHEET 1 OF 1